

- NOTES;
1. ALL EXPOSED METAL AND METALLIZED AREA SHALL BE GOLD PLATED 1.5 μ m MIN. THICKNESS OVER NICKEL PLATED.
 2. SEAL AREA AND DIE ATTACH PAD SHALL BE ISOLATED FROM ANY LEADS. (ZERO GROUND)
 3. * INDICATES DIMENSION OF THE TOP SURFACE.

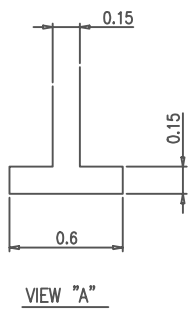

MODIFICATIONS					NAME		TOLERANCES:		DRAWN			
NO.	DESCRIPTION	DATE	DRAWN	CHECKED	APPROVED	SCALE	MATERIAL	UNLESS OTHERWISE SPECIFIED	K.I.	N.U.	S.T.	DATE
1	CHANGED CAV,S/R,THK DIM & B/F EXPOSURE	01.25.'88	Y.S	T.T		10/1	KYOCERA A-440	± 0.13				11.04.'86
2	CHANGED LEAD FRAME FORMING	03.04.'87	K.A	N.U	S.T			THIRD ANGLE PROJECTION				
3	CHANGED W/B PATTERN, 12.9 ± 0.18 → 12.80 ± 0.18	01.21.'87	K.A	N.U	Y.S							
CHANGE					DATE	DRAWN	CHECKED	APPROVED	DRAWING NO.		SHEET	
									PB-F86652-C		1/1	



KYOCERA CORPORATION
KYOTO JAPAN

PGO-20F
DRAWN K.I. CHECKED N.U. APPROVED S.T. DATE 11.04.'86
DRAWING NO. PB-F86652-C
SHEET 1/1